

USDA-FOREST SERVICE

Index

File No. A-7

CORNER RECORD (SEARCH)

(Ref. FSM 7151.4)

Tract or

Survey No. _____

Cor.

No. 1/4

T 3S R. 33E

R.D. Ukiah

County Umatilla

Merid. Willamette

N.F. Umatilla

State Oregon

CORNER DIAGRAM

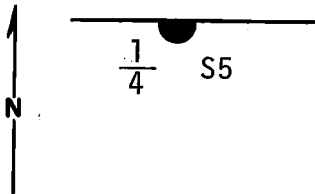

DESCRIBE CORNER MONUMENT FOUND

Could find no evidence of the original post.

DESCRIBE BEARING TREES OR OTHER OFFICIAL ACCESSORIES FOUND Found dead Lodge Pole Pine 10" dia. with opened blaze and visible scribing "1/4S" for SW BT and a P.Pine (live) 25" dia. with opened blaze and visible scribing "1/4S" for NE BT. Measured record dist. from both BT's. At intersection point set up staff compass and shot bearings to old BT's, P.Pine is N42°E and L.P.Pine is S46°W which leads me to believe the original surveyor transposed his numbers in the SW bearing.

PHOTO IDENTIFICATION DATA

Photo No. _____

Filed At. _____

Object Ident. _____

Ident. By _____

Signature

PLANE COORDINATE POSITION DATA

State _____ Zone _____

X _____

Y _____

Estab. By _____

Agency

Signature

Title

Division

Headquarters

Date

7100-52-(3,68)

ORLS

1294

9-77

5

CORNER RECORD (PERPETUATION)

MONUMENT: DESCRIBE NEW MONUMENT SET, OR WORK DONE TO PRESERVE EXISTING MONUMENT

At point of intersections set 2 1/2"x30" galvanized pipe with brass cap stamped:
Set pipe 22" in ground with mound of stone to cap.

T2S R33E
S31

1 | S5
4 | T3S
1980
OR PLS 1294

ACCESSORIES: DESCRIBE NEW BT'S WITNESS OBJECTS ETC. ESTABLISHED, OR WORK DONE TO PRESERVE EXISTING EVIDENCE

Bearing Trees: Old: Dead Lodge Pole Pine 10" dia. bears S46°W, 60.1 ft with visible scribing "1/4S". A Live Ponderosa Pine 25" dia. bears N42°E, 72.6 ft with visible scribing "1/4S".

New: A White Fir 12" dia. bears S80°E, 14.0 ft scribed 1/4 S5 BT.

A Douglas Fir 12" dia. bears S26°W, 29.5 ft scribed 1/4 S5 BT.

Attached 54-3 & 54-4 signs to all BT's. Attached brass washer stamped LS1294 to foot blaze of new BT's. Painted blazes and 6" band around both BT's red. Attached 54-4 sign to metal post 5 ft. East of corner.

Work Done By R. C. Orton Title Party Chief Date 7-31-80 State Registration No. _____
or Agency _____

Certified Cor. Record Prepared? (Yes) No Filed At: _____ Date _____

Witnesses: _____ REMARKS _____

R. Orton
L. Huntsman
D. Allen

Index File No. T. R. M. Tract or Surv. No. Cor. 12

A-7 3S 33E 13

24

8/13/69

Index File No. A-7

CORNER RECORD (SEARCH)

Tract or Survey No. LL 1
Cor. No. A-7

T 3S R. 33E R.D. UKIAH County UMATILLA
Merid. Williams Pt N.F. UMATILLA State OREGON

CORNER DIAGRAM

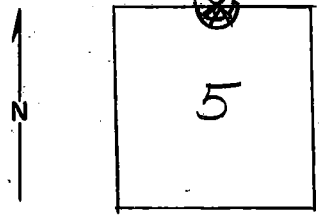

DESCRIBE CORNER MONUMENT FOUND

Rock mound (NOT original), 5" high, 18" broad.
NOT IN CORRECT POSITION.

DESCRIBE BEARING TREES OR OTHER OFFICIAL ACCESSORIES FOUND

P. PINE BT (Living) 23" DBH, BEARS $N42^{\circ}E$, 110 Lks. Visible scribing ".../4S...".
Lodgepole pine BT 9" DBH, BEARS APPROX. $S42^{\circ}W$, 91 Lks from COR. Visible scribing reads ".../4...".

PHOTO IDENTIFICATION DATA

Photo No. 9091166245
Filed At. _____
Object Ident. NONE
Ident. By _____
Signature _____

DESCRIBE CORNER LOCATION RELATIVE TO NEAR-BY FEATURES, ALSO HOW TO REACH CORNER

CORNER IS ON NW-FACING SLOPE ABOVE LITTLE PEARSON CREEK. AREA OF COR. REACHED BY DRIVING UP OLD LOGGING RD. UNTIL ROAD WAS IMPASSABLE, THEN WALKED WITH AID OF AERIAL PHOTO. COR. IS 8.88 CH'S EAST OF THE INTERSECTION OF THE N-S LINE BETWEEN RANGES 32E & 33E, & THE NORTH BOUNDARY OF SEC. 5 IN T35R33E. AREA THICKLY COVERED WITH FIR, SOME PINE.

PLANE COORDINATE POSITION DATA

State _____ Zone _____
X _____
Y _____
Estab. By _____
Agency _____

Signature: Ken Magoon

Title ENG. AIDE Division U.S.F.S. UMATILLA N.F.S.O. Headquarters _____ Date 16 SEPT. 1969
7100-52
REV. 65 5

CORNER RECORD (PERPETUATION)

MONUMENT: DESCRIBE NEW MONUMENT SET, OR WORK DONE TO PRESERVE EXISTING MONUMENT

ACCESSORIES : DESCRIBE NEW BT'S WITNESS OBJECTS ETC. ESTABLISHED, OR WORK DONE TO PRESERVE EXISTING EVIDENCE

FLAGGED (RED) & PAINTED (RED) BT'S AND ROCK MOUND,
POSTED "ATTENTION", "BT", & COR. LOCATION SIGNS.

Work Done By MARVIN BENSON Title ENG'R AIDE Date 8/13/69 State Registration No. U.S.F.S.
or Agency

Certified Cor. Record Prepared ? Yes No Filed At: _____ Date _____

REMARKS
PIN BRICK ON PHOTO IS @ PINE 30" DBH BEARING N13°E, 158 LBS &
NE BT.

Index File No. A-7 T. 35 R. 33E M. WILLAMETTE Tract or Surv. No.

Cor. A-7 13